



**NBB Bohemia s.r.o.**

Výroba a prodej osvětlovací techniky, Sídliště 693, 407 22 Benešov nad Ploučnicí

## Product Data Sheet

Průmyslové LED svítidlo 1275 mm

**TOPLINE LED 52W/840  
OPAL 2L LEDline 120cm  
IP65**



Order number

**910208124**

Unit EAN13 code

**8595209941732**

### General information

Model/Description	<b>LED svítidlo</b>
Finish	<b>Prachotěsné</b>
Brand/Manufacturer	<b>NBB</b>
Material	<b>ABS/PC</b>
Lamp type	<b>eLed line</b>
Nominal service life (h)	<b>45000 h</b>
Degree of protection (IP)	<b>IP65</b>
Dimmable	<b>Ne</b>
Nominal voltage (V)	<b>230 - 240 V</b>
Dimmable by conventional dimmers	<b>Ne</b>
Název položky	<b>TOPLINE LED 52W/840 OPAL 2L LEDline 120cm IP65</b>

### Electrical characteristics

Nominal wattage	<b>52 W</b>
Operating voltage (V)	<b>220 - 240 V</b>
Type of Voltage	<b>AC</b>
Lowest permitted operating voltage (V)	<b>198 V</b>
Nominal current (A)	<b>0,23 A</b>
Total power (W) (light fitting)	<b>57,2 W</b>

### Working conditions

Integrated driver	<b>Ano</b>
Operating frequency	<b>50 - 60 Hz</b>
Light source is part of the fixture	<b>Ano</b>
Working temperature of the ballast body -Tc max	<b>75 °C</b>

Hot restart	Ano
Protection against overvoltage	Ano
Burning position	Libovolná
Installation height (m)	2 - 5 m
Application	Všeobecné osvětlování
Type of control gear	Elektronický nestmívatelný
Ambient temperature	-10/+35 °C

#### Physical characteristics

Numbers of ballasts	1
Finish diffuzor	Opálový
Type of chip	EPISTAR
Dimensions (mm)	1.272 x 158 x 100 mm
Packing method	1 - 6
Weight gross	2500 g
Spacing of fixing holes	900 mm
Colour housing	Bílá
Weight netto	2400 g

#### EuP Parameters

Average Lifetime B50 (h)	45000 h
Number of maximal switching cycles	>250000
The rate of premature failures	<1 %
Colour difference	0,95 %
Rated service life	45000 h
Energy consumption (AGGR)	57,2 kWh/1000h
Equivalent fluorescent lamp	72 W
Turn-on time	0,3 s

#### Lighting characteristics

Dominant wavelength	447 nm
Luminous flux	6400 lm
Colour temperature	4000 K
Colour rendering index CRI	82 Ra
Colour of light	840
Chromaticity coordinates x	0,3805
Chromaticity coordinates y	0,3761

#### Safety information

Insulation class	Třída I
Safety instructions	<a href="http://www.nbb.cz">www.nbb.cz</a>

#### Energetic characteristics

Lamp Power factor (PF)	0,98
Lamp efficacy	123 lm/W

#### Exclusion of liability

Changes to data are subject to prior notice. NBB Bohemia s.r.o. accepts no responsibility for damages caused by inaccurate interpretation of the content on this site.

## Notice

Under the scope of Act 185/2001 Coll. as amended, this product is included in waste group 5 (light sources and luminaires). In view of the harmful effects of mercury on the environment and on human health, the creators of group 5 waste (consumers) are obliged to dispose of used light sources for recycling. Do not throw this product into mixed waste after use. Take it to the nearest store, collection yard, or other designated location for free recycling. You can also dispose of the used products for recycling in our sales outlets or in collection points of collective recycling systems or municipal collection yards. Ecological recycling of waste electrical and electronic equipment is ensured through the RETELA collective system ([www.retela.cz](http://www.retela.cz)).

## Notice (LVD)

LED light sources ranks among electrotechnical products powered by mains 230-240V. For safety reasons, it is recommended that the assembly, connection or disassembly be carried out by a person with an appropriate electrotechnical qualification. When installing or disassembling, it is advisable to disconnect the power supply otherwise there may be a risk of electric shock. Only use the product in the luminaires designed for this type of light source. The manufacturer can not be held responsible for damages resulting from inappropriate connection, connection to an unsuitable distribution system, or damages resulting from mechanical damage to the light source. Observe the operating values on the product. Do not expose the product to inappropriate weathering or high temperatures unless it is expressly stated that the product is intended to be operated under these conditions. When installing, wiring or disassembling, follow the generally accepted safety precautions.

## Notice

Single LED chip failure, luminous flux deviation  $\pm 10\%$  as well as chromaticity deviation  $\pm 150K$  are in compliance with applicable standards and are not a reason for complaint.

## Popis

## Technical drawing

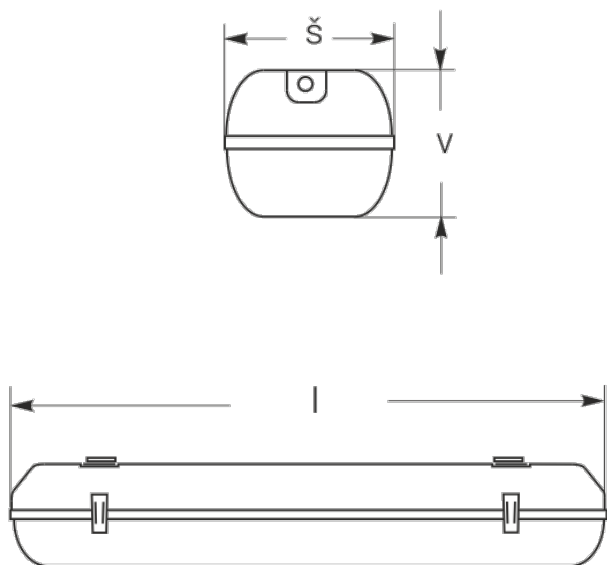

**NBB Bohemia s.r.o., Sídliště 693, 407 22 Benešov nad Ploučnicí**  
<https://www.nbb.cz/en/> | [hotmail@nbb.cz](mailto:hotmail@nbb.cz)

Copyright CE 2024 NBB Bohemia s.r.o. Všechna práva vyhrazena.